

ELEVATION

SECTION-A-A

OPERATION	A1	A2
ELECTRIC DRIVE (UNDER 14' WIDE)	9	6
ELECTRIC DRIVE (14' TO UNDER 20' WIDE)	10	7
ELECTRIC DRIVE (20' WIDE OR WIDER)	11	8

GUIDE DETAILS

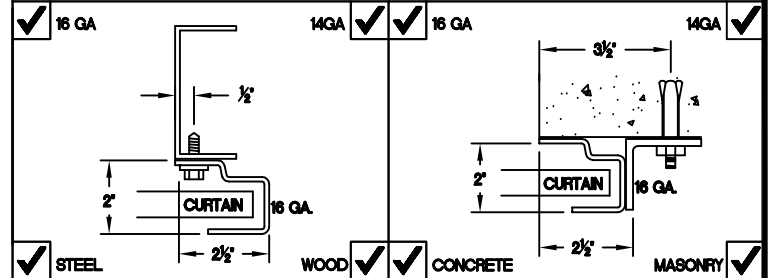

GUIDE DETAILS

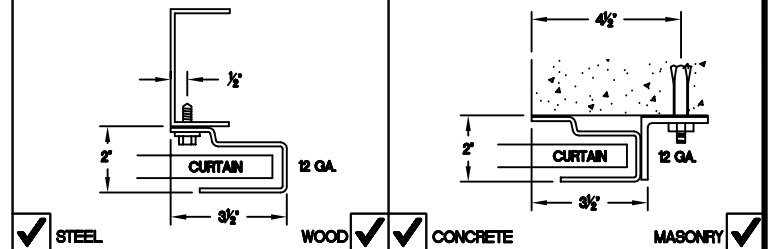

CURTAIN DETAILS



GENERAL NOTES:

CURTAIN:

- 26 GAUGE GALVANIZED STEEL WITH BAKED ON EPOXY PRIMER AND POLYESTER TOP COAT

GUIDES:

- ROLL FORMED ( ) GAUGE GALVANIZED STEEL

OPERATION:

- RIGHT HAND SHOWN, LEFT HAND OPPOSITE

OTHER SURFACES:

- GALVANIZED OR SHOP COAT PRIMER

MRK.	QTY.	OPENING SIZE		OPERATION	R.H.	CLEARANCES		OPTION	PROJECT:			
		WIDTH 'W'	HEIGHT 'H'			L.H.	'X'		'V'	ARCHITECT:	CONTRACTOR:	DISTRIBUTOR:
									200 SERIES SHEET DOOR WITH MEDIUM DUTY JACKSHAFT MOTOR			



4255 McEver Industrial Dr.  
Acworth, GA 30101  
PH(770) 974-2800  
Fax(770) 974-1455  
www.astadoor.com

Asta Door Corporation is not responsible for the use of improper installation procedures, structural supports as well as field inspection prior to manufacturing and installation.

APPROVAL SIGNATURE: \_\_\_\_\_

DATE: \_\_\_\_\_